

REVISIONS		
DATE	L.S. NAME	LIC. NO.
NOV. 2007	JAMES D. McEWEN	#31659

KEY MAP

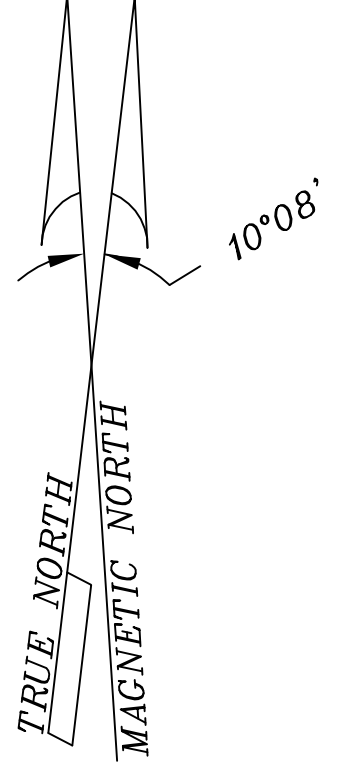
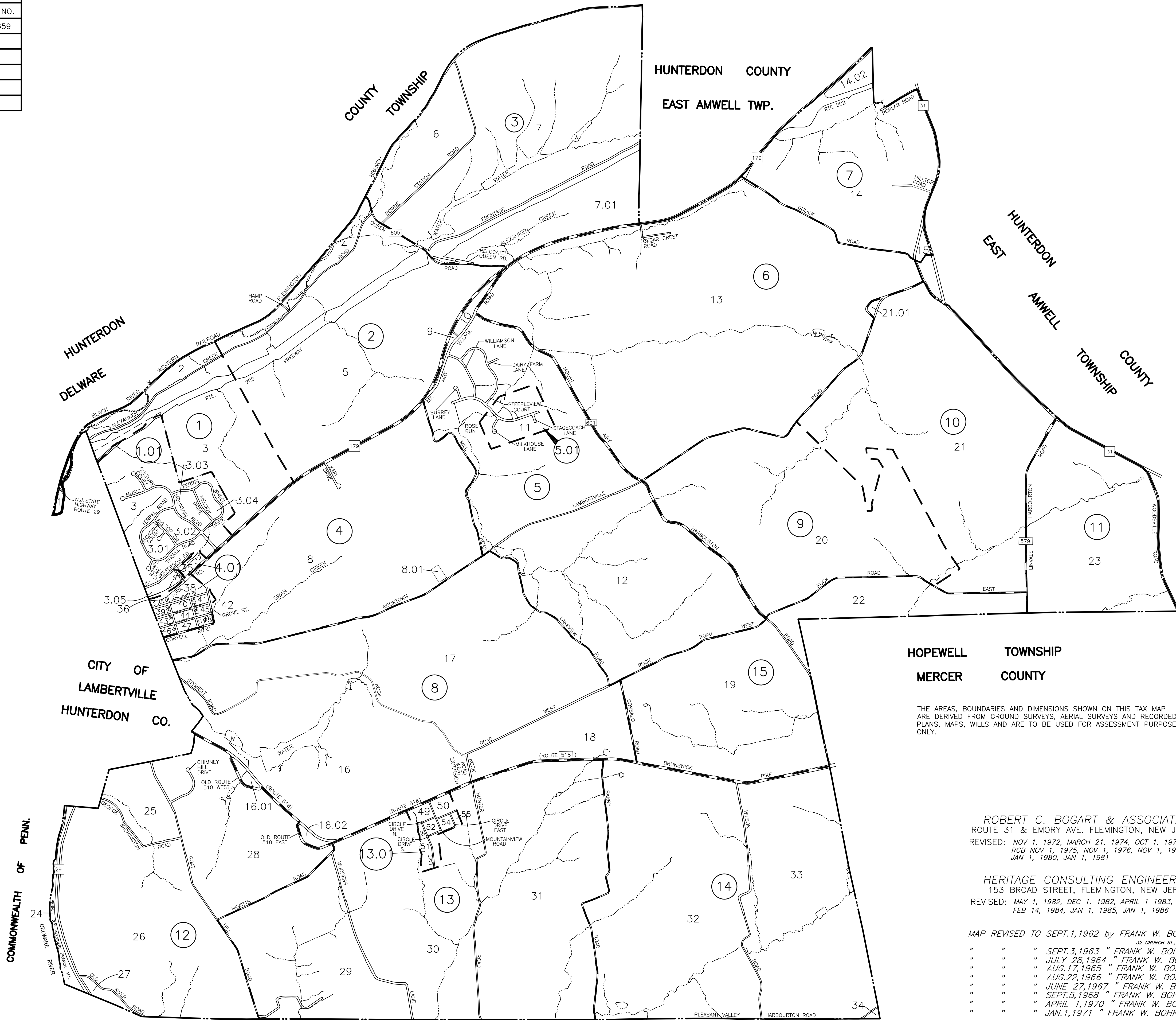

NEW JERSEY DEPARTMENT OF THE TREASURY
 DIVISION OF TAXATION
 PROPERTY ADMINISTRATION
 APPROVED AS A TAX MAP PURSUANT TO THE AUTHORITY OF
 N.J.A.C. 17:27 & 17:28
 FOR THE DIRECTOR DIVISION OF TAXATION
 James J. Coll, Chief, Local Assessment/Compliance
 Santo C. DiDonato, Supervising Field Representative
 DATE: DEC 29 2003 SERIAL NO. 825

HOPEWELL TOWNSHIP
MERCER COUNTY

THE AREAS, BOUNDARIES AND DIMENSIONS SHOWN ON THIS TAX MAP ARE DERIVED FROM GROUND SURVEYS, AERIAL SURVEYS AND RECORDED PLANS, MAPS, WILLS AND ARE TO BE USED FOR ASSESSMENT PURPOSES ONLY.

VAN CLEEF ENGINEERING ASSOCIATES
 1128 ROUTE 31, LEBANON, NEW JERSEY

REVISED: FEB. 2, 1988, JAN 11, 1989, JAN 10, 1990
 DEC. 1, 1990, DEC. 27, 1990, JAN 2, 1992, JAN. 4, 1993,
 JAN. 4, 1996

FEB., 1988 ERROL MELNICK, P.L.S. N.J. #34013
 OCT., 1988 ERROL MELNICK, P.L.S. N.J. #34013
 JAN., 2001 CARL M. HERRMAN, P.L.S. N.J. #42271
 JAN., 2003 CARL M. HERRMAN, P.L.S. N.J. #42271
 DEC., 2003 CARL M. HERRMAN, P.L.S. N.J. #42271
 JAN., 2006 JAMES D. McEWEN, P.L.S. N.J. #31659
 OCT., 2006 JAMES D. McEWEN, P.L.S. N.J. #31659
 NOV., 2007 JAMES D. McEWEN, P.L.S. N.J. #31659

ROBERT C. BOGART & ASSOCIATES
 ROUTE 31 & EMORY AVE. FLEMINGTON, NEW JERSEY
 REVISED: NOV 1, 1972, MARCH 21, 1974, OCT 1, 1974, MAY 1, 1975
 RCB NOV 1, 1975, NOV 1, 1976, NOV 1, 1977
 JAN 1, 1980, JAN 1, 1981

HERITAGE CONSULTING ENGINEERS
 153 BROAD STREET, FLEMINGTON, NEW JERSEY
 REVISED: MAY 1, 1982, DEC 1, 1982, APRIL 1 1983, DEC 1, 1983
 FEB 14, 1984, JAN 1, 1985, JAN 1, 1986

MAP REVISED TO SEPT. 1, 1962 by FRANK W. BOHREN, C.E.
 " " " SEPT. 3, 1963 " FRANK W. BOHREN, C.E.
 " " " JULY 28, 1964 " FRANK W. BOHREN, C.E.
 " " " AUG. 17, 1965 " FRANK W. BOHREN, C.E.
 " " " AUG. 22, 1966 " FRANK W. BOHREN, C.E.
 " " " JUNE 27, 1967 " FRANK W. BOHREN, C.E.
 " " " SEPT. 5, 1968 " FRANK W. BOHREN, C.E.
 " " " APRIL 1, 1970 " FRANK W. BOHREN, C.E.
 " " " JAN. 1, 1971 " FRANK W. BOHREN, C.E.

- LEGEND**
- (13) DETAIL SHEET NUMBER
 - 30 BLOCK NUMBER
 - DETAIL SHEET LIMIT
 - [518] COUNTY ROAD SYMBOL
 - [31] STATE ROAD SYMBOL

THIS SHEET IS A DIGITIZED COPY PREPARED BY ARH ENGINEERS AND SURVEYORS, 850 S. WHITE HORSE PIKE, HAMMONTON, N.J. OCTOBER 2005. THE ORIGINAL APPROVED TAX MAP WAS PREPARED BY AERO SERVICE CORPORATION AND OTHERS. THE ORIGINAL APPROVED MAP IS ON FILE IN THE OFFICE OF THE ENGINEER.

NEW JERSEY DEPARTMENT OF THE TREASURY
 DIVISION OF TAXATION
 PROPERTY ADMINISTRATION
 APPROVED AS A TAX MAP PURSUANT TO THE PROVISIONS OF CHAPTER 175 LAWS OF 1913
 BY C.E. BARNES
 STATE SUPERVISOR
 DATE: DEC 21 1959 SERIAL NO. 260

"TO SHOW CONDITIONS AS OF NOV., 2007"
WEST AMWELL TOWNSHIP TAX MAP
 HUNTERDON COUNTY NEW JERSEY
 SCALE: 1" = 1500' OCTOBER 1959
 AERO SERVICE CORPORATION
 210 E. COURTLAND STREET PHILADELPHIA, PA

KEY MAP